

DIGITRON SEMICONDUCTORS

MECHANICAL CASE OUTLINE PACKAGE DIMENSIONS

DATE 16 NOV 2012

CASE DIGI L AXIAL LEADED

CASE	HERMETICALLY SEALED GLASS BODY
MARKING	BODY PAINTED, ALPHA NUMERIC
POLARITY	CATHODE BAND
WEIGHT	0.400 GRAMS (APPROXIMATE)

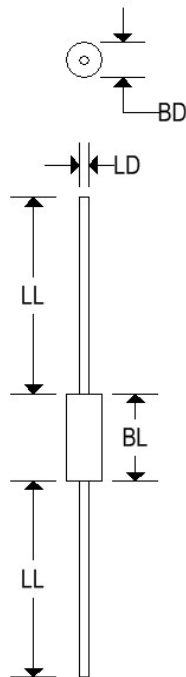

	Digi L			
	Inches		Millimeters	
	Min	Max	Min	Max
BD	-	0.110	-	2.794
BL	-	0.235	-	5.969
LD	0.028	0.032	0.711	0.813
LL	1.000	-	25.400	-

This drawing is for reference only. Please refer to Digitron's published datasheet.